

ENGLISH

Before starting

This guide has information and operations required for start up. For further instructions, refer to the Instruction Manual (PDF).

■ Viewing the Instruction Manual (PDF) on this unit

You can view the Instruction Manual on this unit.

1. Tap "Manual" in the home screen.
 - The instruction manual is displayed. (A Wi-Fi connection is required.)
 - To view the Instruction Manual on a computer, download it from our website.
<http://www.jp.onkyo.com/audiovisual/dap/>

Supplied Accessories

USB cable



Names of the parts

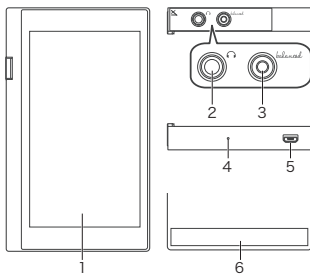

1. Display (touch panel)
2. Headphone jack
3. Headphone jack (balanced output jack)
4. Microphone
5. microUSB port (also used for recharging)
6. Built-in antenna

The antenna is built into the main unit. The transmission speed of the unit may be adversely affected if you block the antenna area with your hand.

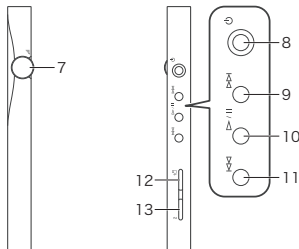

7. Volume dial
Turn the dial to adjust the volume. You can also adjust the volume with touch operations on the display.
8. Power button (⏻)
Press and hold the power button to turn the power on or off. To turn the screen on or off, just press the button.
9. Skip (▶▶) button
Skip to the next track.
10. Play/pause (▶/⏸) button
11. Skip (◀◀) button
Skip to the previous track.
12. microSD card slot 1
13. microSD card slot 2

Charging

Use the USB cable (supplied) to connect this unit to a computer that is running.

- Connect so the wider side of the plug is up. You may damage the plug or jack if you try to insert it the wrong way.

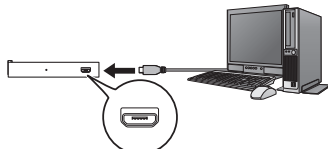

- The battery is not charged at the time of purchase. Please charge it before use.
- If the unit is off, an icon is displayed on the screen and charging starts.
- You can also charge while the unit is on. The time for charging may increase in this case.

Turning the power on/off

Turning the power on

1. Press and hold the power button (⏻) to turn the power on.

Turning the power off

1. Press and hold the power button (⏻).
2. Tap "Power off".
 - The power turns off.

Making initial settings

Press and hold the power button (⏻) to turn the power on.

- A setup wizard is displayed when you turn this unit on for the first time. Follow the instructions on the screen to set the following items.
- Select the language
- Setup Wi-Fi®
 - Tap the name of the access point you want to connect to and then enter the password.
- Set the date and time
- Enter user information
- Set the Google™ account
 - Tap "Add your account" or "Or create a new account" and make the settings according to the instructions on the screen.
- Tap "FINISH" in the final screen.
- A user agreement is displayed. Read the content and tap "Agree".
 - The home screen is displayed when these initial settings are complete.

Basic operations

The home screen is displayed when these initial settings are complete. The following describes the main operations of the icons displayed at the bottom of the home screen.



	Returns to the previous screen.
	Displays the home screen.
	Displays recently used applications.

Listening to music on this unit

This explains how to use the data copy software to copy music files from a Windows computer to this unit and play them. You can also play from an SD card or download files from websites that distribute music. For these other methods, see the instruction manual.

■ Copy music files from a computer to this unit

1. Download the installer for the "X-DAP Link" data copy software to your computer.

<http://www.jp.onkyo.com/audiovisual/dap/>

2. Double-click setup.exe to install "X-DAP Link".
 - The setup wizard is displayed, so follow the on screen instructions to install. A shortcut icon is created on the desktop when installation is completed.
3. Connect this unit to the computer with the supplied USB cable and start "X-DAP Link".



4. Select the folder that contains the file(s) you want to copy from ❶ to display a list of music files in the middle of the screen.

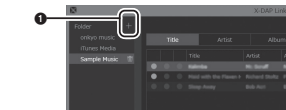

5. Click ❷ to select "Built-in storage", "SD card 1", or "SD card 2" as the copy destination, then click "OK".
 - You can also click ❸ and ❹ to specify different copy destinations other than ❷.
 - To copy to a microSD card, insert a microSD card into the card slot.
6. Select the music files you want to copy in the list displayed in the middle of the screen. Select the check boxes to the left of the music files that match the copy destination. Select to copy to the destination selected by ❷ (blue)

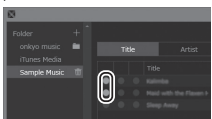

Select to copy to the destination selected by ❷ (yellow)

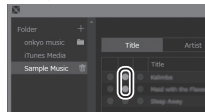

Select to copy to the destination selected by ❹ (pink)

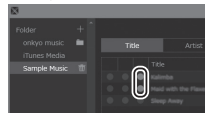

7. Click the copy button ❸ for the color selected above.
 - It may take some time until the music content appears in the library of this unit.

■ Playing Music

1. Tap the "Music" player in the home screen.
 - The "Music" player starts.



2. Tap the track you want to start play.

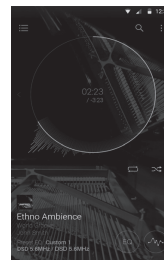

■ Specifications

Platform:
Android5.1

Display:
4.7 inch, 720×1280 dot resolution

Interfaces and input/output jacks:

Headphone jack 1
Headphone jack (balanced output jack) 1
microUSB jack 1, microSD card slot 2

Network Section:

Wireless LAN: IEEE802 b/g/n/ac compliant
Bluetooth®: A2DP, AVRCP, HSP, OPP, HID, PAN

Input Rating:
5 V dc, 1.5 A

Battery power:
1,630 mAh

Operating temperature range:
5 °C to 35 °C

Internal memory:
32 GB (including system area for Android)

Mass of main unit:
203 g (7.2 oz)

External dimensions (excluding protrusions):
129 mm × 75.9 mm × 12.7 mm
(5-1/16" × 3" × 1/2") (height/width/depth)

Specifications and features are subject to change without notice.

■ License and Trademark Information

- Google and Android are trademarks or registered trademarks of Google Inc.
- Microsoft® and Windows® are trademarks or registered trademarks of Microsoft Corporation in the United States and other countries.

■ DISCLAIMER

Through this device you are able to link to other services or websites which are not under the control of any company which has designed, manufactured or distributed this device, and its affiliates (collectively, "Company"). We have no control over the nature, content and availability of those services. The inclusion of any links does not necessarily imply a recommendation or endorse the views expressed within them. All information, content and services available through this device belong to third parties and are protected by copyright, patent, trademark and/or other intellectual property laws of applicable countries.

The information, content and services provided through this device are for your personal, noncommercial use only. Any information, content or services may not be used in any manner other than previously approved by the appropriate content owner or service provider.

You may not modify, copy, republish, translate, exploit, create derivative works, upload, post, transmit, sell or distribute in any manner any information, content or services available through this device, unless expressly permitted by the appropriate copyright, patent, trademark and/or other intellectual property owner, including, without limitation, content owner or service provider. THE CONTENT AND SERVICES AVAILABLE THROUGH THIS DEVICE ARE PROVIDED "AS IS". COMPANY DOES NOT WARRANT INFORMATION, CONTENT OR SERVICES SO PROVIDED, EITHER EXPRESSLY OR IMPLIEDLY, FOR ANY PURPOSE. COMPANY EXPRESSLY DISCLAIMS ANY WARRANTIES, EXPRESS OR IMPLIED, INCLUDING BUT NOT LIMITED TO, WARRANTIES OF TITLE, NON-INFRINGEMENT, MERCHANTABILITY OR FITNESS FOR A PARTICULAR PURPOSE.

Company makes no representation or warranty of any kind, express or implied, about the completeness, accuracy, validity, legality, reliability, suitability or availability with respect to the information, content or services available through this device. Company shall not be liable, whether in contract or tort, including negligence and strict liability, for any direct, indirect, special, incidental or consequential damages or any other damages arising out of, or in connection with, any information contained in, or as a result of the use of any content or service by you or any third party, even if Company has been advised of the possibility of such damages, nor shall Company be liable for any third party claims against users of this device or any third party. In no event shall Company be responsible nor liable for, without limiting the generality of the foregoing, any interruption or suspension of any information, content or service available through this device. Company is neither responsible nor liable for customer service related to the information, content and services available through this device. Any question or request for service relating to the information, content or services should be made directly to the appropriate content owners and services providers.